

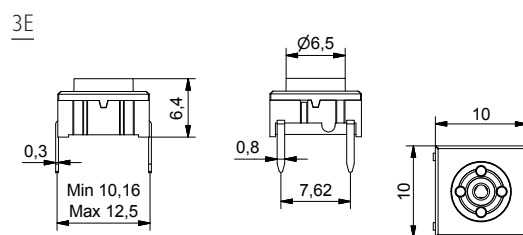

- Through-hole (TH) or surface mount (SMD)
- 50mA/24VDC
- Single pole/momentary
- 10,000,000 operations lifetime
- Temperature range:
 - Low temp.: -40/+115C
 - High temp.: -40/+160C
- IP 67 sealing
- Actuation force: 3.5N

All dimensions in mm

THROUGH-HOLE (TH)

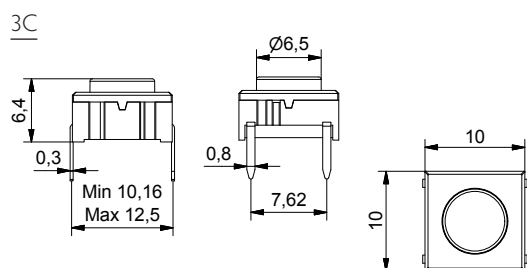

PCB LAYOUT

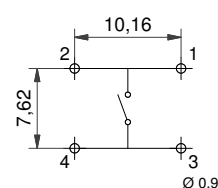

SURFACE MOUNT (SMD)

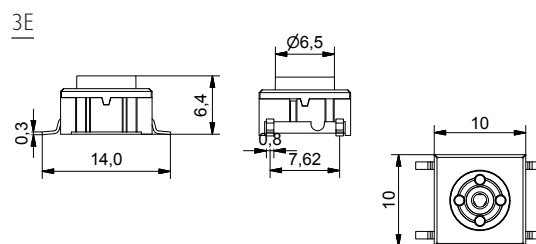
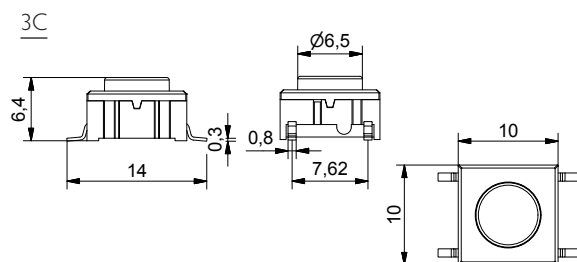

PCB LAYOUT

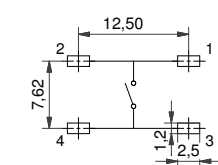

3FTL6RAS W/LED

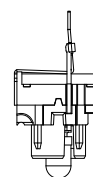
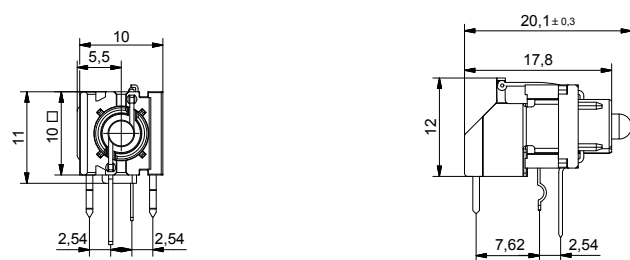

PCB LAYOUT

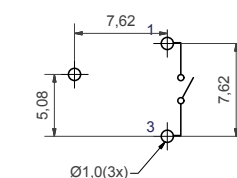

HOW TO ORDER

Switch	Mounting	Temperature range
3 C	<input type="checkbox"/> <input type="checkbox"/> <input type="checkbox"/>	<input type="checkbox"/> <input type="checkbox"/>
	T through-hole S surface mount	L6 low temp. white L9 low temp. black H9 high temp.

Switch	Mounting	Temperature range
3 E	<input type="checkbox"/> <input type="checkbox"/> <input type="checkbox"/>	<input type="checkbox"/> <input type="checkbox"/>
	T through-hole S surface mount	L9 low temp. black H9 high temp.

Switch	LED	Right angle support
3 F T L 6	<input type="checkbox"/> <input type="checkbox"/> <input type="checkbox"/> <input type="checkbox"/>	R A S
through-hole low temp	00 blue 20 green 40 yellow	60 white 80 red 2040 green/yellow
		8020 red/green 8040 red/yellow

3FTL6RAS with LED can be used with the 3 series keycaps: 1D, 1E, 1F, 1K, 1N, 1Q, 1R, 1S, 1T, 1U, 1V, 1WA, 1WD, 1WP, 1X. Ask further information on caps from MEC.

Ordering example: 3CTL6, 3ESH9, 3FTL6RAS Please see colour codes, updates of products and changes of specifications on www.mec.dk